

# STEELIE®

## CAR MOUNT KIT



**MAGNETIC PHONE SOCKET**



**MAGNETIC PHONE SOCKET ADHESIVE BACKING**

### MAGNETIC PHONE SOCKET INSTALLATION INSTRUCTIONS:

THE MAGNETIC PHONE SOCKET CAN BE ADHERED DIRECTLY TO THE BACK OF MOST PHONES AND HARD CASES. SEE NOTE BELOW FOR IPHONE 4/4S WITHOUT A CASE.

1. CLEAN THE BACK OF THE PHONE/PHONE CASE WITH THE ENCLOSED ALCOHOL PAD. LET DRY. DO NOT USE HOUSEHOLD CLEANERS.
2. REMOVE THE ADHESIVE BACKING FROM THE MAGNETIC PHONE SOCKET.
3. POSITION THE MAGNETIC PHONE SOCKET IN THE CENTER OF THE BACK OF THE DEVICE AND FIRMLY PRESS INTO PLACE.
4. WAIT ONE HOUR AFTER APPLICATION FOR SUFFICIENT CURE.

**FOR IPHONE 4/4S WITHOUT A CASE (OR ANY PHONE WITH A GLASS BACK),** AFTER CLEANING ACCORDING TO INSTRUCTIONS ABOVE, PLACE THE ENCLOSED CLEAR DISK ONTO THE CENTER OF THE BACK OF PHONE AND THEN ADHERE MAGNETIC PHONE SOCKET TO THE CLEAR DISK FOLLOWING INSTRUCTIONS ABOVE.

**DO NOT USE THIS PRODUCT ON SOFT, FLEXIBLE CASES.** THESE CASES ARE NOT RIGID ENOUGH TO HOLD THE MAGNETIC PHONE SOCKET.

IN THE EVENT THAT YOU MUST USE THE MAGNETIC PHONE SOCKET WITH A SOFT, FLEXIBLE CASE: REMOVE THE CASE FROM YOUR PHONE, PLACE THE CASE ON A SOLID SURFACE AND CUT A HOLE IN THE CASE WHERE THE MAGNETIC PHONE SOCKET WILL BE APPLIED. ADHERE MAGNETIC PHONE SOCKET DIRECTLY TO THE HARD SURFACE BELOW, THROUGH THE NEW HOLE IN CASE.

### DASH BALL MOUNT INSTALLATION INSTRUCTIONS:

1. BEFORE REMOVING ADHESIVE BACKING, TEST THE POSITION OF THE DASH BALL MOUNT IN A FEW DIFFERENT PLACES ON DASH.  
FOR BEST RESULTS, TEST WITH PHONE ATTACHED TO DASH BALL MOUNT TO CHOOSE LOCATION.
- 2A. CLEAN THE CHOSEN AREA WITH THE ENCLOSED ALCOHOL PAD.  
DO NOT USE HOUSEHOLD CLEANERS.  
IF THE DASH BALL MOUNT WILL BE INSTALLED ONTO A HARD SURFACE SUCH AS HARD PLASTIC, METAL, OR WOOD VENEER, PROCEED TO STEP 3.
- 2B. **IF THE DASH BALL MOUNT WILL BE INSTALLED ONTO A SOFT TEXTURED SURFACE SUCH AS A VINYL CAR DASH OR ON RUBBER,**  
FIRST APPLY THE ENCLOSED 3M PRIMER TO THE SURFACE.  
*(PRIMER IS SAFE FOR VINYL AND WILL NOT DAMAGE SURFACE)* SQUEEZE THE 3M PRIMER STICK AT THE DOT TO WET THE FELT TIP. RUB THE PRIMER ONLY ONTO THE IMMEDIATE AREA WHERE THE DASH BALL MOUNT WILL BE PLACED AND ALLOW THE PRIMER TO DRY FOR 5 MINUTES.
3. PEEL THE ADHESIVE BACKING FROM THE DASH BALL MOUNT AND PRESS FIRMLY INTO PLACE.
4. **WAIT 24 HOURS BEFORE APPLYING DEVICE TO DASH BALL MOUNT TO ALLOW SUFFICIENT CURE TIME FOR ADHESIVE.**

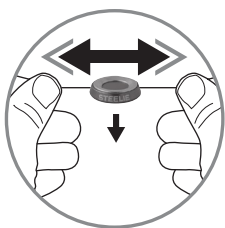

### REMOVAL INSTRUCTIONS:

1. APPLY A FEW DROPS OF RUBBING ALCOHOL BETWEEN THE STEELIE COMPONENT AND THE SURFACE OR DEVICE IT HAS BEEN APPLIED TO IN ORDER TO BREAK THE ADHESIVE BOND.
2. CAREFULLY USE FISHING LINE OR DENTAL FLOSS IN A SAWING MOTION TO CUT FOAM AWAY FROM THE SURFACE OR DEVICE. (SEE ILLUSTRATION BELOW) USING YOUR FINGER, ROLL REMAINING ADHESIVE AWAY FROM APPLIED SURFACE.  
**CAUTION!** USE OF SHARP EDGES TO REMOVE ADHESIVE IS NOT RECOMMENDED, AS IT MAY RESULT IN SCRATCHES OR DAMAGE TO DEVICES AND/OR OTHER SURFACES!
3. DO NOT RE-USE 3M ADHESIVE. NEW ADHESIVES CAN BE PURCHASED WITHIN A REINSTALL KIT AT [WWW.NITEIZE.COM](http://WWW.NITEIZE.COM).

### MAGNET WARNING—PLEASE READ

THE STEELIE CONTAINS A STRONG MAGNET. THE MAGNET WILL NOT DAMAGE PHONES OR TABLETS WITH SOLID STATE HARD DRIVES (INCLUDING IPHONES, IPADS, ETC.) AS APPLE HAS SHOWN WITH THE IPAD SMARTCOVERS. HOWEVER, MAGNETS CAN DAMAGE SENSITIVE OBJECTS INCLUDING PACEMAKERS, COMPUTER HARD-DRIVES, FLOPPY DISKS, CREDIT CARDS, MAGNETIC I.D. CARDS, CASSETTE TAPES, VIDEO TAPES AND OTHER SIMILAR ITEMS. CERTAIN TELEVISIONS, VCRS, COMPUTER MONITORS AND OTHER CRT DISPLAYS MAY ALSO BE AFFECTED. NITE IZE ASSUMES NO LIABILITY FOR DAMAGE TO SUCH OBJECTS.

KEEP OUT OF REACH OF CHILDREN. MAGNETS CAN BE HARMFUL IF SWALLOWED.